

# Features & Benefits

## Overlap Awning

### 1. *Framing*

Crestlite® Overlap Awning is available in Front Glaze framing section and is adaptable with centre pocket framing. The 38mm sash incorporates a double sealing system on the frame to improve high weathering performance and the sash overlaps the exterior frame for increased performance as well as sealing.

### 2. *Glazing*

The Crestlite® Overlap Awning Window has a number of glazing options for energy efficiency and acoustic requirements. Glazing is available in 6mm toughened glass through to 25mm double glazed units. Large single lite windows are available.

### 3. *Energy Efficiency Options*

Trend® Thermashield® in various glazing styles are available to help reduce energy consumption. Trend® Thermashield® means greater control, bigger savings and most importantly one less thing to worry about.

### 4. *Acoustic options*

SoundMizer® acoustic awning solutions are available. Acoustic solutions can reduce aircraft, highway traffic, railway and other annoying noise problems. For information or technical details contact Trend®.

### 5. *Finishes*

Powdercoated finishes are available in a range of colours and finishes including Warranty Powders and Anodised options to suit most commercial applications.

### 6. *Hardware*

Heavy duty stainless steel friction stays and cam handles are standard in non-keyed or keyed upgrades. Restricted opening is also a standard for High Rise situations.

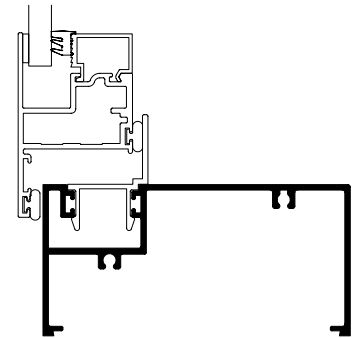
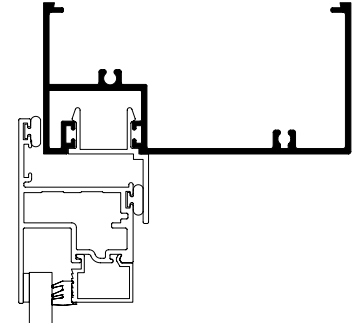

Please note that drawings are not to scale

**Crestlite® Overlap Awning | Code | Mk-4 | 1 Jul 2009**

# Installation

Overlap Awning | Building In Details | **Generic Detail**

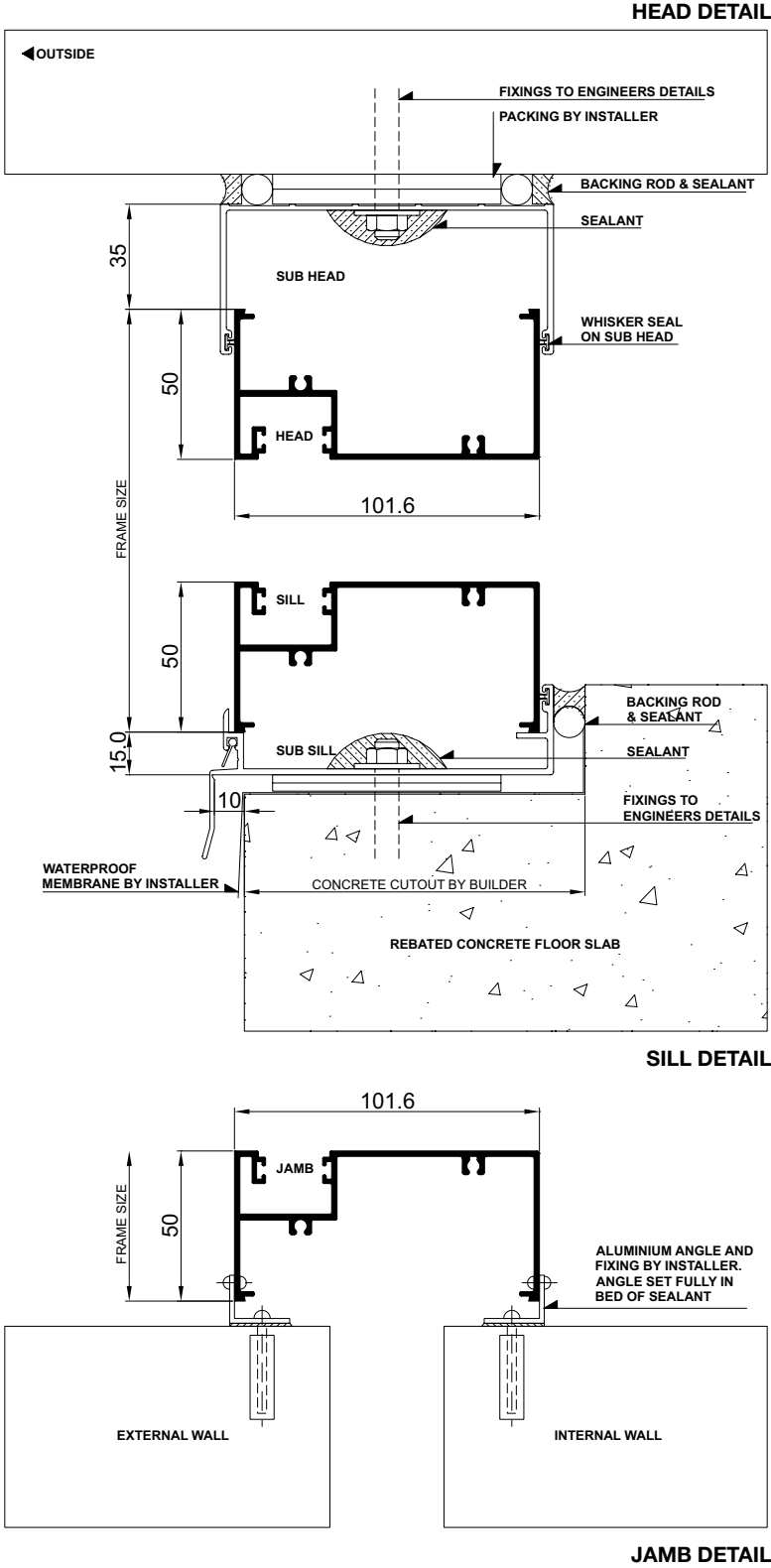

Please note that drawings are not to scale  
**Crestlite® Overlap Awning | Code | Mk-4 | 1 Jul 2009**

Confidentiality Notice: This document and the information it contains are copyright and confidential to Trend® Windows & Doors Pty Limited. Disclosure, use and copying in any form whatsoever, except as authorised by Trend® Windows & Doors in writing, are strictly prohibited. Patents and Design Registrations pending.

# Cross Sectional Views

Overlap Awning | **Single Lite**

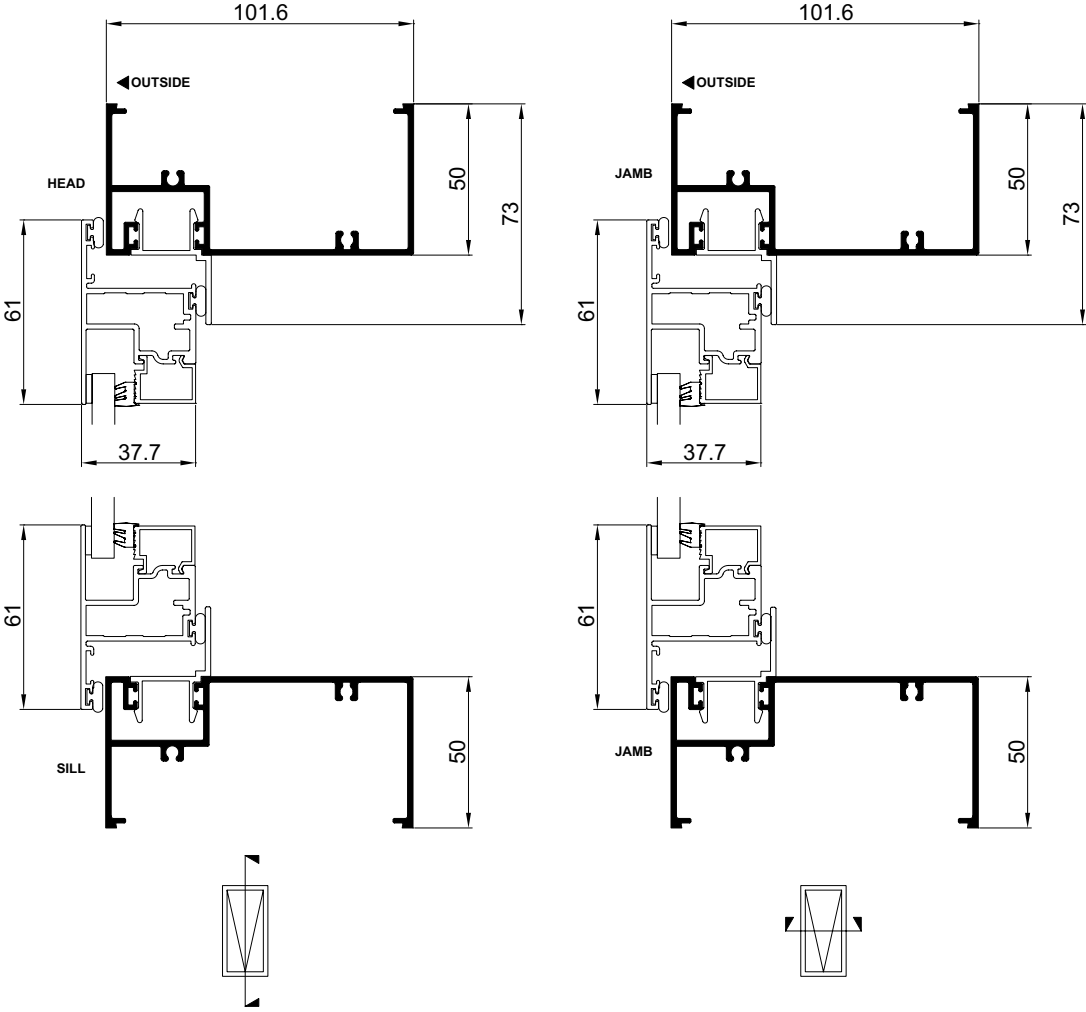

Please note that drawings are not to scale  
**Crestlite® Overlap Awning | Code | Mk-4 | 1 Jul 2009**

Confidentiality Notice: This document and the information it contains are copyright and confidential to Trend® Windows & Doors Pty Limited. Disclosure, use and copying in any form whatsoever, except as authorised by Trend® Windows & Doors in writing, are strictly prohibited. Patents and Design Registrations pending.

# Cross Sectional Views

Overlap Awning | **Two Lite with Lowlite**

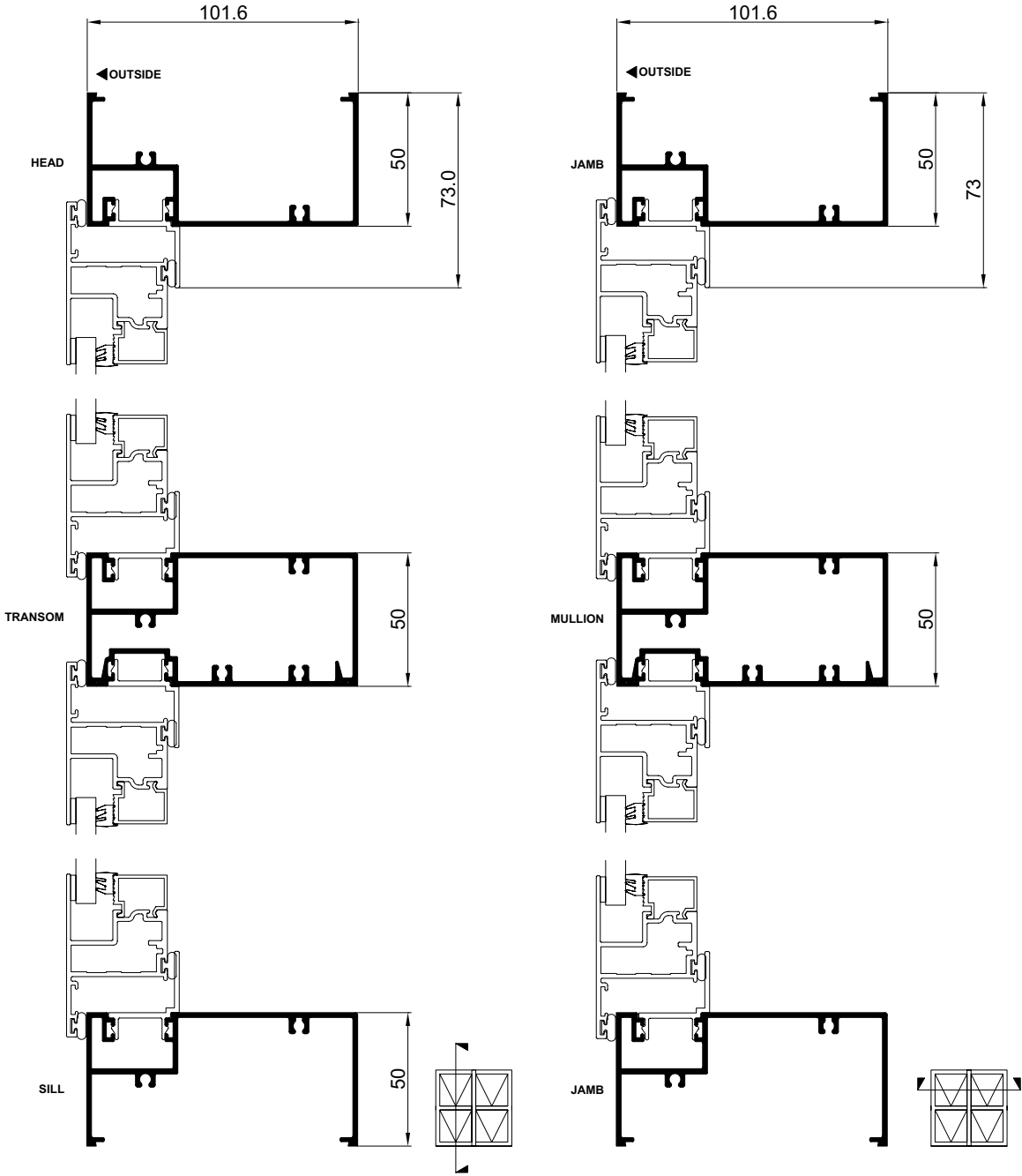

Please note that drawings are not to scale

**Crestlite® Overlap Awning | Code | Mk-4 | 1 Jul 2009**

Confidentiality Notice: This document and the information it contains are copyright and confidential to Trend® Windows & Doors Pty Limited. Disclosure, use and copying in any form whatsoever, except as authorised by Trend® Windows & Doors in writing, are strictly prohibited. Patents and Design Registrations pending.