

Xtreme[®] Aluminium

Internal Offset Framing

TECHNICAL DATA

Features & Benefits

Size Range

Ordering Details

Installation

Cross Sectional Views

Please note that drawings are not to scale

Xtreme[®] Internal Offset Framing | A-CR-OF E | Mk 6 | 26 Oct 2009

Confidentiality Notice: This document and the information it contains are copyright and confidential to Trend[®] Windows & Doors Pty Limited. Disclosure, use and copying in any form whatsoever, except as authorised by Trend[®] Windows & Doors in writing, are strictly prohibited. Patents and Design Registrations pending.

Features & Benefits

Xtreme® Internal Offset Framing

*Xtreme® Windows & Doors have been tested to AS1530.8.1 (2007), and comply to Section 8 Construction Service Bushfire Attack Level 40 (BAL-40), Radiant Heat Level 40kW/m², AS3959 (2009). For full details of Standards requirements for individual products please refer to Trend Windows & Doors Technical Department.

- 1 **Energy Efficiency Options**
Trend® Thermashield® in various glazing styles are available to help reduce energy consumption. Trend® Thermashield® means greater control, bigger savings and most importantly one less thing to worry about. Energy efficient options to u-value of 2.6 and SHGC 0.55 are available for Trend.
- 2 **Acoustic options**
SoundMizer® acoustic solutions in various STC ratings, are available to STC 37 for Trend. SoundMizer® acoustic solutions can reduce aircraft, highway traffic, railway and other annoying noise problems. For information or technical details contact Trend®.
- 3 **Frame**
The Xtreme® Internal Offset Framing offers a commercial look for apartments, high end residential, or wherever a commercial frame is required. This robust frame allows for large fixed lite applications for greater viewing area. Overall frame width is 101.6mm
- 4 **Glazing**
The Xtreme® Internal Offset Framing has a number of glazing options for energy efficiency and acoustic requirements. Glazing is available in 5mm toughened glass through to 24mm double glazed units. Large single lite picture windows can have a maximum area of 2.4m²
- 5 **Operable Windows**
The Xtreme® Internal Offset Framing offers the ability to have operable windows inserted into the frame for greater flexibility and ventilation options.

Other Xtreme® products in various styles and openings can be inserted into the Trend® Internal Offset Framing to give a more commercial look while allowing ventilation. These include hinged doors.
- 6 **Finishes**
Powdercoated finishes are available in a range of colours and finishes. Warranty finishes are available as well as anodised options to suite most commercial applications. Decowood woodgrain finish is also available with the Xtreme® range.

**For Size Range and Ordering Details
Contact Trend Windows & Doors
Sales Office for further details**

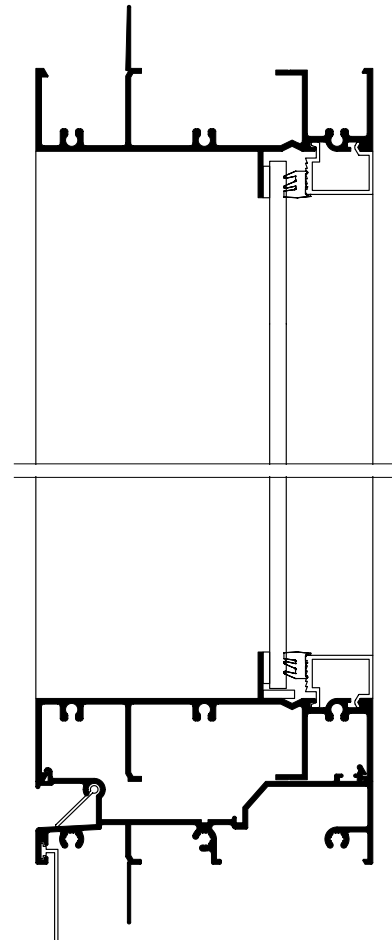

(This may vary however. For more information on variations to this please contact you Trend Sales Executive)

Glazing is all done internally

Please note that drawings are not to scale

Xtreme® Internal Offset Framing | A-CR-OF E | Mk 6 | 26 Oct 2009

Confidentiality Notice: This document and the information it contains are copyright and confidential to Trend® Windows & Doors Pty Limited. Disclosure, use and copying in any form whatsoever, except as authorised by Trend® Windows & Doors in writing, are strictly prohibited. Patents and Design Registrations pending.

Installation

Xtreme® Internal Offset Framing | Building In Detail | **Brick Veneer - 230mm wall**

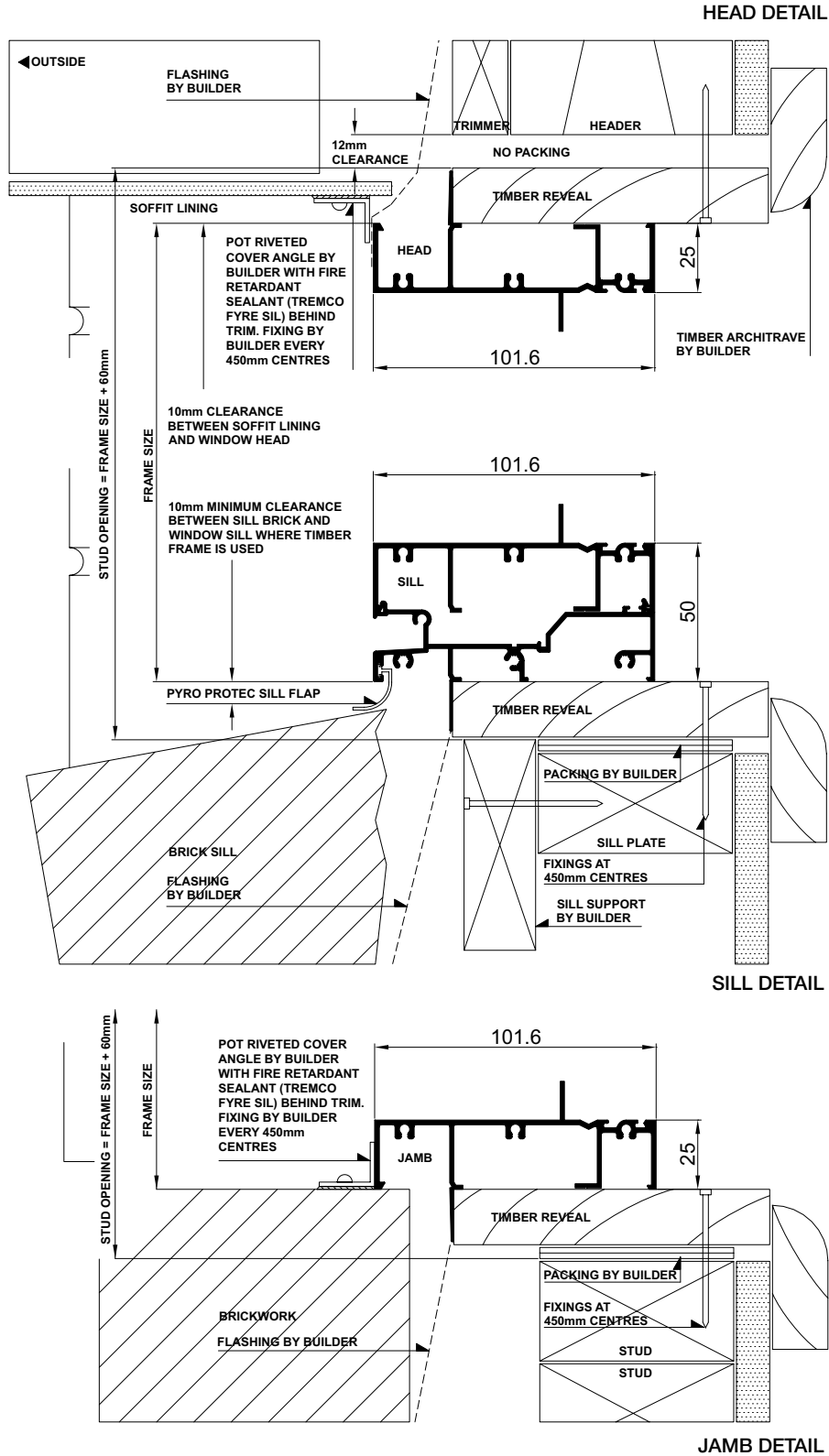

Please note that drawings are not to scale

Xtreme® Internal Offset Framing | A-CR-OF E | Mk 6 | 26 Oct 2009

Confidentiality Notice: This document and the information it contains are copyright and confidential to Trend® Windows & Doors Pty Limited. Disclosure, use and copying in any form whatsoever, except as authorised by Trend® Windows & Doors in writing, are strictly prohibited. Patents and Design Registrations pending.

Installation

Xtreme® Internal Offset Framing | Building In Detail | **Double Brick - 280mm wall**

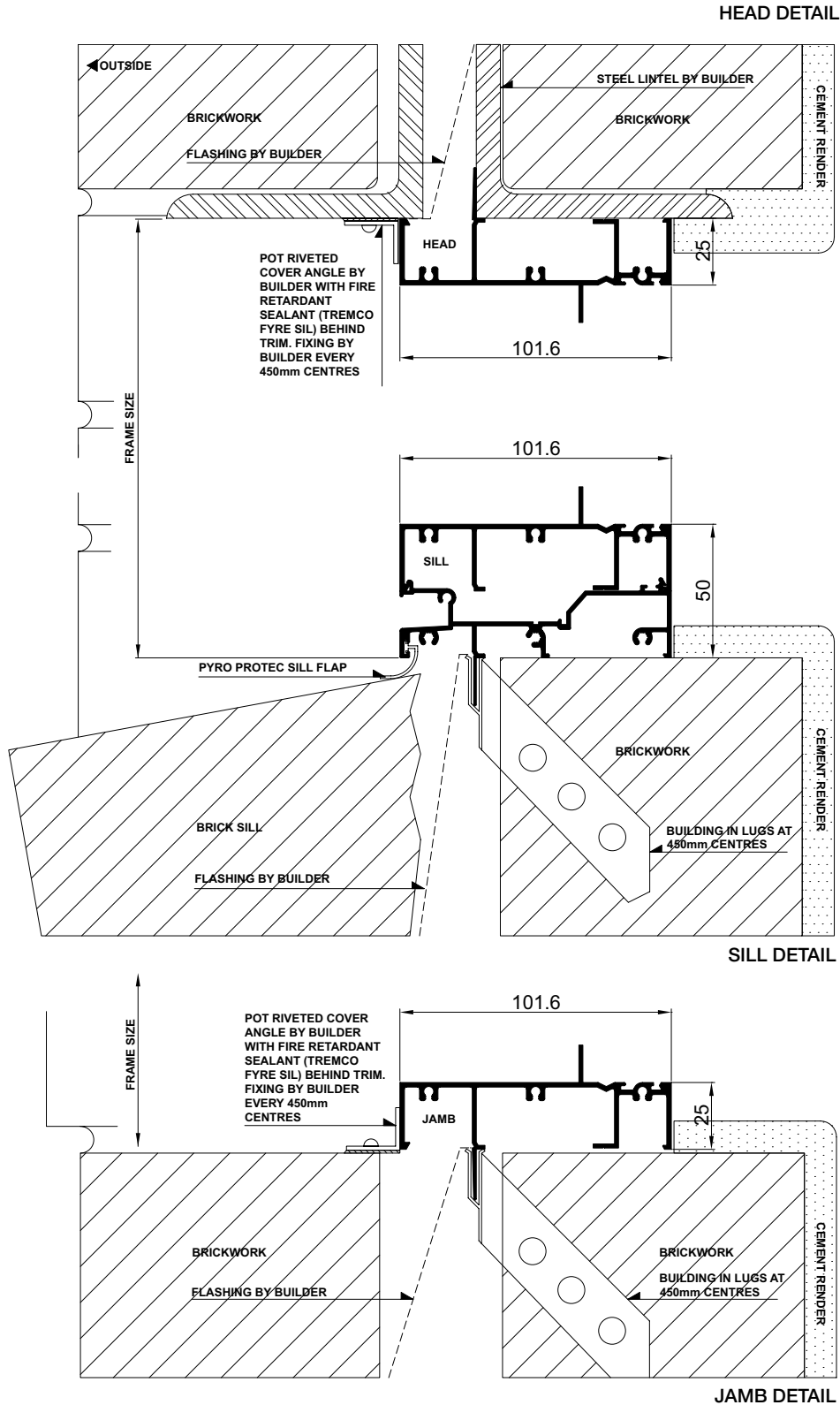

Please note that drawings are not to scale

Xtreme® Internal Offset Framing | A-CR-OF E | Mk 6 | 26 Oct 2009

Confidentiality Notice: This document and the information it contains are copyright and confidential to Trend® Windows & Doors Pty Limited. Disclosure, use and copying in any form whatsoever, except as authorised by Trend® Windows & Doors in writing, are strictly prohibited. Patents and Design Registrations pending.

Cross Sectional Views

Xtreme® Internal Offset Framing | **Standard 2 Lite**

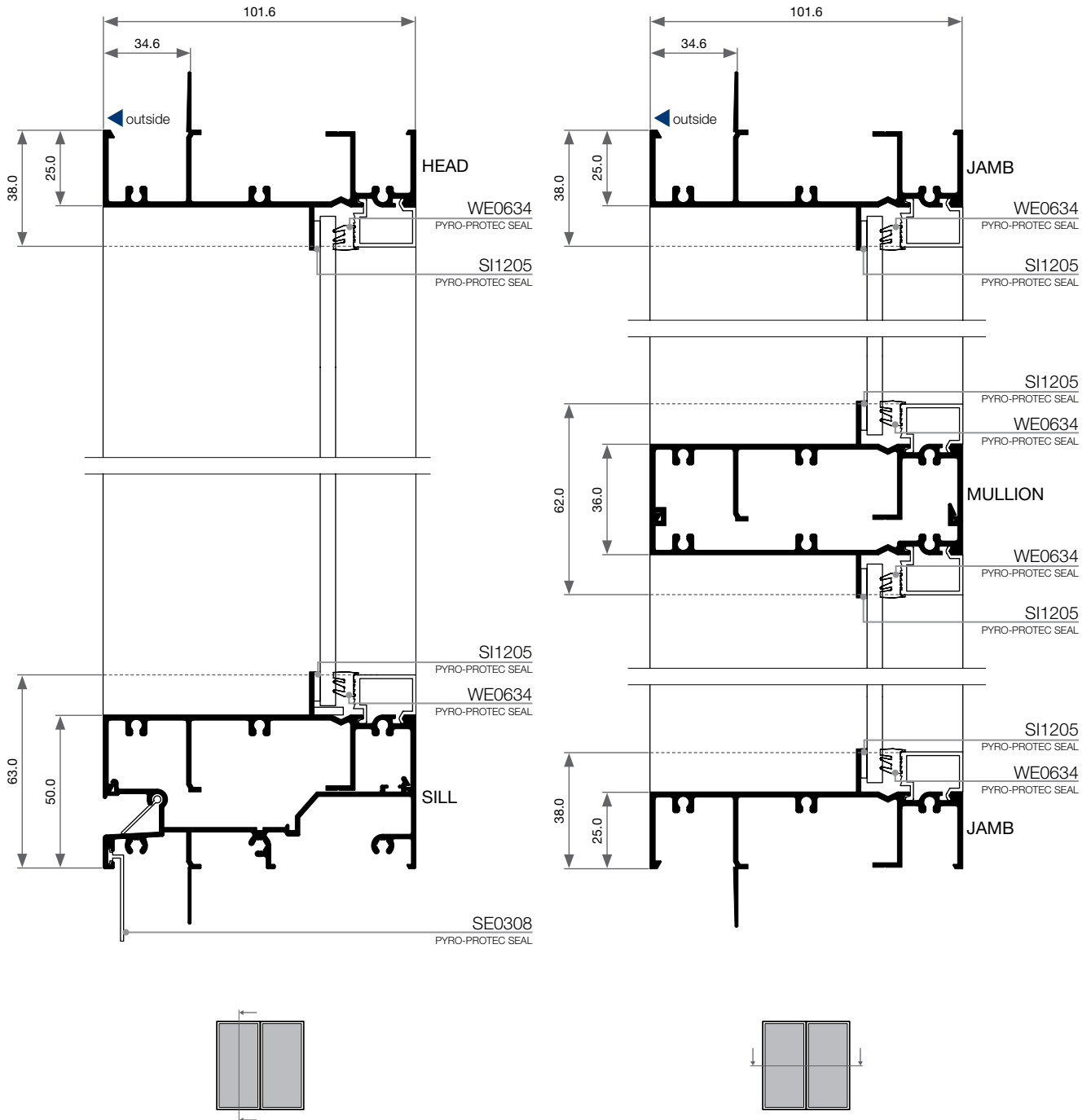

Please note that drawings are not to scale

Xtreme® Internal Offset Framing | A-CR-OF E | Mk 6 | 26 Oct 2009

Confidentiality Notice: This document and the information it contains are copyright and confidential to Trend® Windows & Doors Pty Limited. Disclosure, use and copying in any form whatsoever, except as authorised by Trend® Windows & Doors in writing, are strictly prohibited. Patents and Design Registrations pending.

Cross Sectional Views

Xtreme® Internal Offset Framing | Quantum Awning Sash Insert

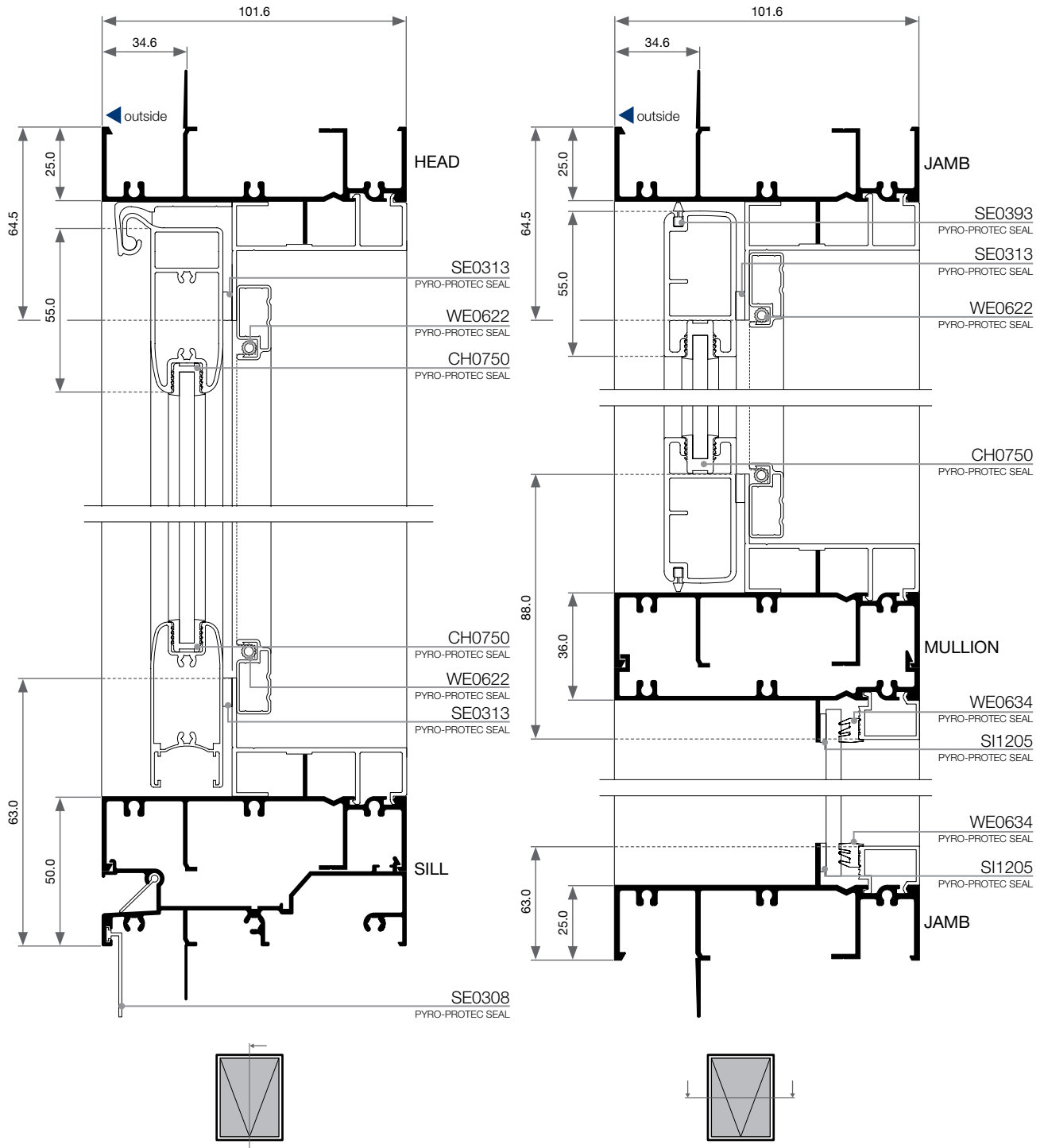

Please note that drawings are not to scale

Xtreme® Internal Offset Framing | A-CR-OF E | Mk 6 | 26 Oct 2009

Confidentiality Notice: This document and the information it contains are copyright and confidential to Trend® Windows & Doors Pty Limited. Disclosure, use and copying in any form whatsoever, except as authorised by Trend® Windows & Doors in writing, are strictly prohibited. Patents and Design Registrations pending.